

## ADMINISTRATION

Athletics Website  
Main Phone Number

www.buhuskies.com  
570-389-4050

Director of Athletics  
Associate Director of Athletics/SWA  
Faculty Athletic Representative  
Director of Athletic Operations  
Director of Athletic Communications

Dr. Michael McFarland  
Kathleen Heitzman  
Dr. Molly Marnella  
Elijah Morgan  
Mary Raskob  
Mike Gilger

Head Athletic Trainer  
Assistant Athletic Trainer  
Assistant Athletic Trainer  
Assistant Athletic Trainer  
Assistant Athletic Trainer  
Equipment Manager  
Strength and Conditioning  
Student-Athlete Advocate  
Athletics Secretary  
Athletics Secretary

Dr. George Salvaterra  
Dr. Kristin Funk Maguire  
Allison Brooks  
Syrena Hess  
Kathryn Weaver  
Ryan Flanagan  
Brandon Michael  
Andrew Foran  
Courtney Noll  
Albree Boone  
Brenda Pitonyak

## COACHING STAFF

Baseball  
Basketball (Men's)  
Basketball (Women's)

Mike Collins  
Chris Bess  
Alison Tagliaferri  
Alyssa Carsia  
Amy Varano  
Bernie Empie  
Kristin Stam  
Nikki Hartranft  
Courtney Noll  
Frank Sheptock  
Paul Johnson  
Mark Ross

Cheerleading  
Cross Country / Track and Field (M/W)

Field Hockey

Football

Eugene Jones IV  
Stephen Pribble  
Cody Castor  
Kevin Seabrook  
Gary Sohosky  
Shannon Hertz  
Mark Bassett  
Matt Haney

Golf (Men's/Women's)  
Lacrosse (Women's)  
Soccer (Men's)  
Soccer (Women's)  
Softball

Swimming (M/W)

Tennis (M/W)  
Volleyball (Women's)  
Wrestling

Susan Kocher  
Dee Wolfe  
Stu Marvin  
Bridget Hilferty  
Rebecca Helt  
Dan Kreiger  
Marcus Gordon  
Russ Hughes

## DIRECTIONS



Bloomsburg is located 75 miles from the PA/NJ border on Interstate 80.

Coming from ...

- **East:** Use I-80 west to Exit 236A. Merge right onto 487 south.

- **West:** Use I-80 east to Exit 236. Turn left at end of ramp.

- **South (Harrisburg area):** Take routes 11 and 15 north then to 487 north.

- **Southeast Pennsylvania:** Take Northeast Extension of the Pennsylvania Turnpike (I-476) to I-80 west (Pocono Exit) to Exit 236A. Merge right onto 487 south.

- **North of Bloomsburg (Scranton/Wilkes-Barre area):** Take I-81 to I-80 west to Exit 236A.

- **Williamsport area:** Take I-180 south to I-80 east to Exit 236. Turn left at the end of the ramp.

**From Exit 236 / 236A:** Take route 487 south approximately two miles. Turn right at the traffic light onto Pettit and go up the hill for athletic facilities.

**From South and West (Rt 11):** Take route 487 north and turn left at first traffic light onto Pettit Way and go up the hill for athletic facilities.

**For GPS Users:** Type in 59 Pettit Way, Bloomsburg, PA, 17815, which will get you to the edge of Upper Campus where the Pettit Athletic Complex is located.



**BLOOMSBURG  
HUSKIES**

## GUIDE FOR VISITING PETTIT ATHLETIC COMPLEX

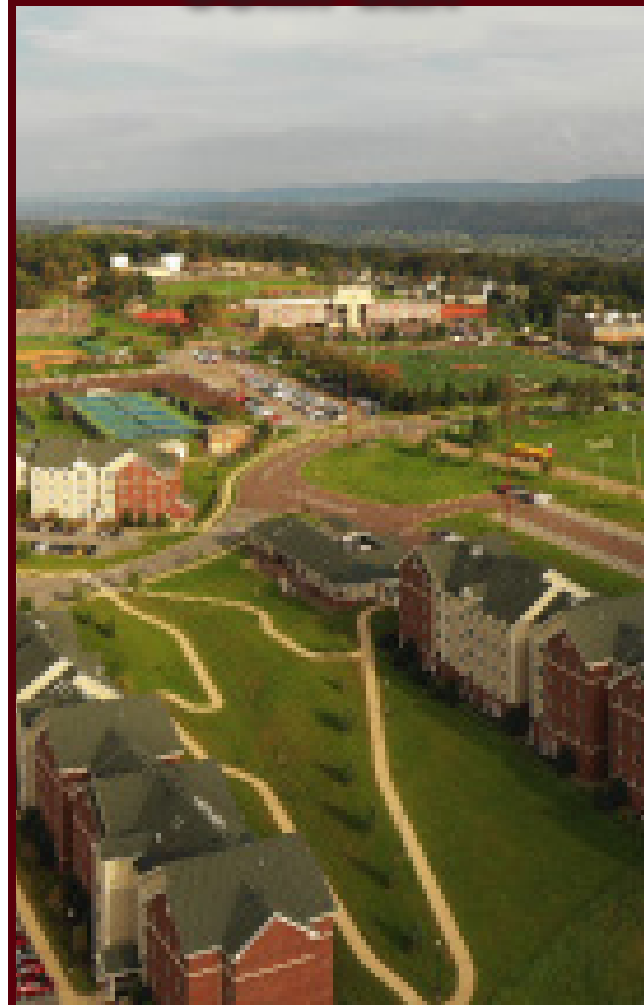

**2022-23**

## CORPORATE PARTNERS

*While in the Bloomsburg area, please patronize our food and lodging corporate partners ...*

**Fairfield Inn & Suites**  
1065 Alliance Park Drive  
Bloomsburg, Pa. 17815  
(570) 416-2777

**Holiday Inn Express**  
14 Mitchell Drive  
Bloomsburg, Pa. 17815  
(570) 387-6702

**Hampton Inn**  
255 Paper Mill Road  
Bloomsburg, Pa. 17815  
(570) 380-1020

**Pine Barn Inn**  
1 Pine Barn Place  
Danville, Pa. 17821  
(570) 275-2071

**Applebee's**  
939 Columbia Boulevard  
Bloomsburg, Pa. 17815  
(570) 387-3334

**Perkins**  
23 Ricky Avenue  
Bloomsburg, Pa. 17815  
(570) 784-1140

**Marley's Brewery & Grille**  
1323 Columbia Boulevard  
Bloomsburg, Pa. 17815  
(570) 784-9600

**Pine Barn Inn**  
1 Pine Barn Place  
Danville, Pa. 17821  
(570) 275-2071

**Naps Pizza**  
319 East Street  
Bloomsburg, Pa. 17815  
(570) 387-0511

**Quaker Steak & Lube**  
211 Columbia Mall Drive  
Bloomsburg, Pa. 17815  
(570) 389-9464

**Olive Garden**  
52 Plaza Drive  
Bloomsburg, Pa. 17815  
(570) 784-2229

**Steph's Subs**  
150 East Main Street  
Bloomsburg, Pa. 17815  
(570) 784-5750

**GIANT**  
1000 Scott Town Plaza  
Bloomsburg, Pa. 17815  
(570) 389-9004

**Weis Markets**  
725 Columbia Boulevard  
Bloomsburg, Pa. 17815  
(570) 387-6183



Bloomsburg University of Pennsylvania is committed to affirmative action by way of providing equal educational and employment opportunities for all persons without regard to race, religion, gender, age, national origin, sexual orientation, disability, or veteran status.

## LOCKER ROOMS

Visiting team locker rooms are located on the lower level of Nelson Field House. Upon entering the field house, please follow directional signs to your locker room. Towels and locks are not provided; however, locker room entry doors are equipped with keypad locks. The code will be provided to the head coach prior to and/or on the day of the contest.

Bloomsburg University is not responsible for lost or stolen items.

## ATHLETIC TRAINING

The Bloomsburg University athletic training staff will allow visiting teams access to: ice, water, an area for taping, and moist heat. Visiting teams must bring their own training supplies such as tape.

A team physician will be present for all home football games and wrestling matches as well as other selected contests. An ambulance will be on-site for all football games.

The training room facility is located on the lower level of the Nelson Field House. The facility is open two hours prior to a competition and will remain open for 30 minutes after a competition.

Athletic Training Phone Number: 570-389-4369

## GAME DAY

### VISITING TEAM TAILGATES

\$25 per group who communicates plans in advance  
\$50 per group who requests accommodations day of event

Basic reservations include: trash can, recycling bin, two tables, assigned tailgate location (if available).

### Checks made payable to CGA-Husky Fund

For any team needs on game day or leading up to game day, please contact athletic operations at 570-389-3907.

### PETS

No pets, other than service animals, are allowed inside any of the Bloomsburg University athletic facilities. Any individual(s) that bring pets with them will be asked to stay outside of the gates at all outdoor facilities. Absolutely no pets, other than service animals, will be permitted inside Nelson Field House.

## TEAM BUS/VAN PARKING

Parking instructions for team buses/vans will be provided to the head coach prior to the date of the contest. For any parking-related questions, please contact athletic operations at 570-389-3907.

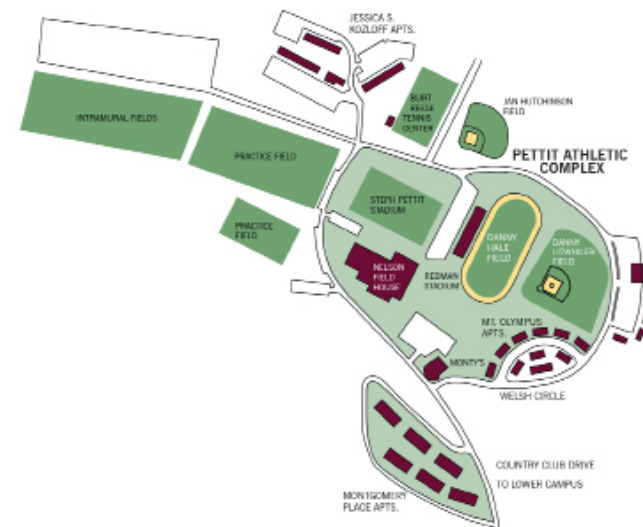

## TICKETS

Bloomsburg University charges admission at football, basketball, and wrestling - all other sports are free of charge. Visit [buhuskies.com/tickets](http://buhuskies.com/tickets) or call 570-389-3907 to purchase tickets in advance of the contest.

### FOOTBALL

All tickets are general admission. Adults are \$10 and students/seniors (Age 62 and older) are \$5. Children five and under are free. Gates open two hours prior to event start time. Tickets can also be purchased at the main entrance to Redman Stadium.

### BASKETBALL/WRESTLING

All tickets are general admission. Adults are \$10 and students/seniors (age 62 and older) are \$5. Children five and under are free. Doors open 90 minutes prior to event start time. Tickets can also be purchased at the main entrance to Nelson Field House.

### GROUPS

Group discounts are available. Please call 570-389-3907 to make group arrangements.

### NOTE

Ticket prices may vary during postseason play as prices are set by the PSAC, the MAC, or the NCAA. Students from BU and PSAC schools are admitted free to all PSAC playoff games with valid ID. The one exception is the PSAC football championship game, where ONLY Bloomsburg students with ID would be admitted for free.